

## H2-A-W4



### **SUPER-RAIL** **Eco Base Plated System**

The H2-A-W4 Super-Rail system is used on high speed roads to provide protection to both large and small vehicles. This system is a base plated system eliminating the need for driven posts and obtains an ASI value "A".

All steel sections are galvanised providing long term maintenance free protection from corrosion.

H2-A-W4

Safety Barrier



Technical Data: SUPER-RAIL ECO Build

H2-A-W4

Test Standard Acceptance Test Testing Institute	DIN EN 1317 Part 1 and Part 2 TB 11 and TB 51 TÜV Süd Germany
Containment Impact Severity Level Working Width	H2 A W4
Test Length System Height System Weight	60 m 0,80 m 47 kg/m Profile A, 46 kg/m Profile B

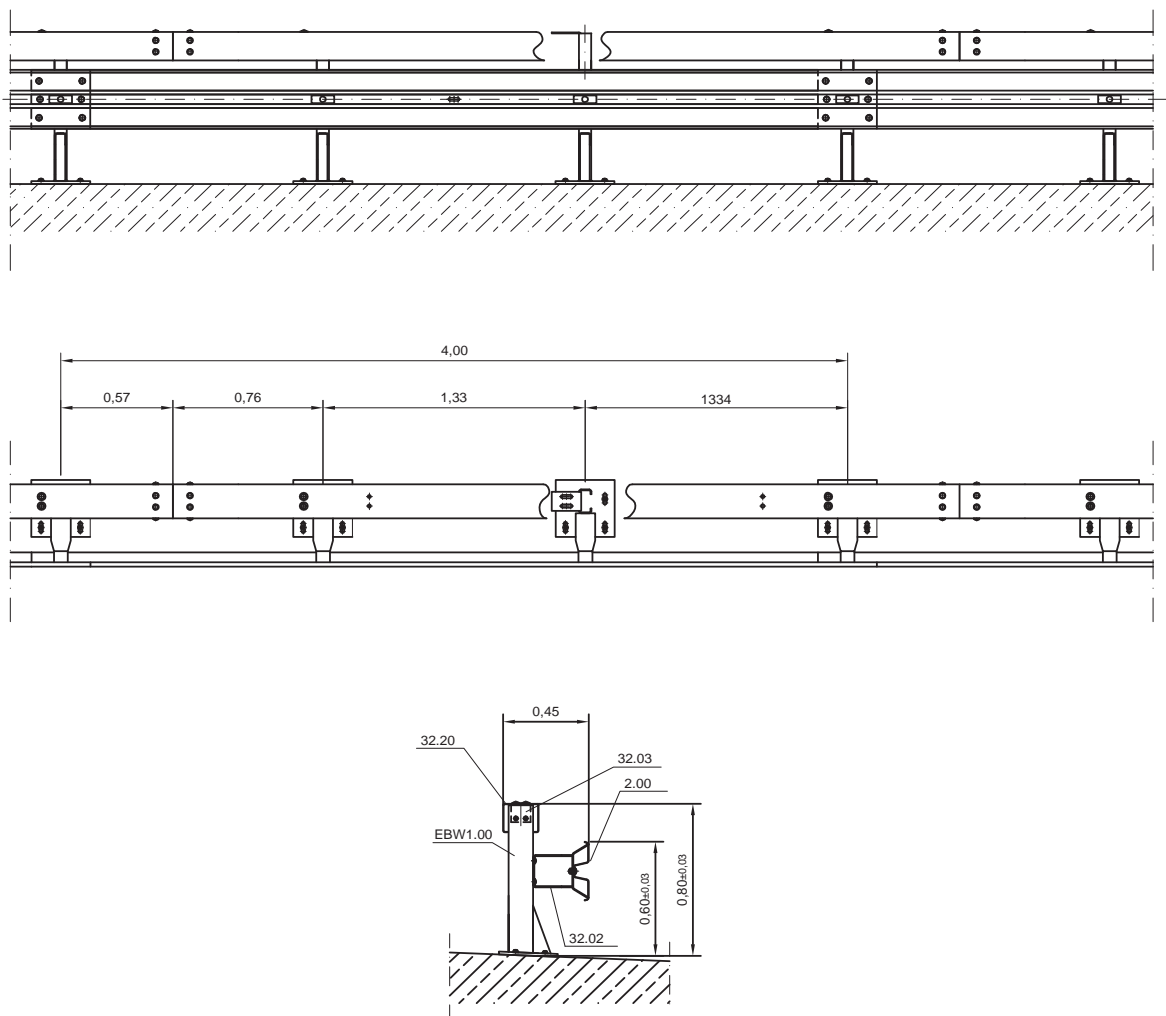

website : [www.jpki.ie](http://www.jpki.ie)  
 email : [info@jpki.ie](mailto:info@jpki.ie)  
 telephone : +353 91 798 146

**PASS+CO**  
 BARRIER SYSTEMS GmbH